

Revel Spacer Installation Instructions

Installation Instructions

For Adding a 2½" Spacer on Top of the Front Air Cylinder Assemblies on a Ram 1500 with Air Ride

 **WARNING:** Improper installation can result in suspension failure, poor handling, or air line damage. Professional installation by a certified technician is strongly recommended. Not responsible for altered products. Installing these spacers on an air ride Ram without using our links will result in air ride warnings and drivability issues.

Tools & Materials Needed:

- Floor jack & jack stands (or a lift)
- Lug wrench
- Metric Sockets & wrenches
- Torque wrench
- Trim tool or pry bar
- 2½" front spacers
- Safety gear (gloves, eye protection)

Installation Instructions:

1. Preparation

- Park the Truck on level ground, engage the parking brake.
- Disable air suspension via Uconnect (Jack or Transport Mode) or pull the air suspension fuse.
- Disconnect the negative battery terminal.

2. Raise the Vehicle

- Loosen front lug nuts.
- Lift the front of the truck and secure with jack stands.
- Remove front wheels.

3. Access the Front Air Strut Assembly

- Remove the plastic inner fender liner (may or may not be needed).
- Remove sway bar bolt and move sway bar.
- Disconnect ABS lines.

4. Disconnect the Air Line

- Disconnect the air line carefully using the correct tool and cap it.
- Remove factory air suspension sensor link.

5. Remove the Strut Assembly

- Place jack under lower control arm
- Remove upper ball joint bold and remove from knuckle (Strike side of knuckle with hammer)
- Remove tie rod bolt and remove from knuckle (Strike side of knuckle with hammer)
- Remove the three top strut nuts and the lower control arm bolt.
- Lower jack enough to remove strut.
- Carefully remove the strut assembly.

6. Install the 2½" Spacer

- Install stud bolts into spacer.
- Mount the spacer to the top of the air strut using the provided hardware.
- Ensure correct orientation.

7. Reinstall the Strut Assembly

- Place the strut with spacer back into position.
- Reinstall lower strut bolt
- Raise lower control arm with jack until strut is seated in top mount. Secure with factory nuts. (Torque to 40 ft-lbs)
- Reinstall upper ball joint in knuckle. (Torque to 70 ft-lbs)
- Reattach ABS lines.
- Reconnect the airline.
- Reattach tie rod and sway bar.
- Check for proper torque on all fasteners.
- Repeat all steps on the other side of the Truck.
- Install Revel adjustable sensor links (on air ride Rams)

8. Reinstall Wheels & Lower the Truck

- Reinstall wheels and torque lug nuts (130 ft-lbs).
- Lower the vehicle.

9. Reactivate Air Suspension

- Reconnect battery.
- Re-enable air suspension system.
- Start the vehicle and allow the system to re-pressurize.

10. Final Checks

- Test drive at low speed.
- Inspect for leaks or errors.
- Get a professional alignment.

✔ These spacers do not lift the vehicle by increasing spring preload, but by repositioning the strut mounting height.

⊘ VOID: Improper installation or incompatible parts could void your vehicle's warranty.

INSTALLATION INSTRUCTIONS

FOR ADDING A 2½" SPACER ON TOP OF THE FRONT AIR CYLINDER ASSEMBLIES ON A RAM 1500 WITH AIR RIDE



WARNING Improper installation can result in suspension failure, poor handling, or air line damage. Always follow the spacer kit manufacturer's specific instructions and ensure all parts are compatible with *Ram 1500^{ar}*

Raise the Vehicle

- Disable the air suspension
- Disconnect the negative battery terminal

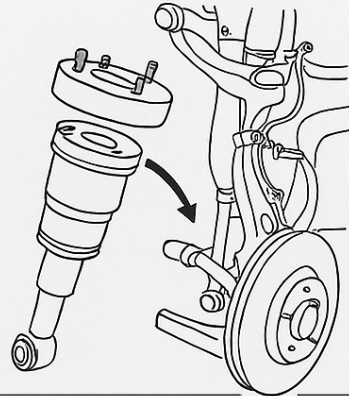
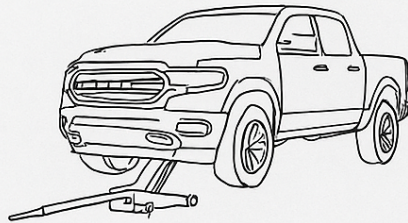

Remove the Strut Assembly

Release the air pressure and disconnect the air line

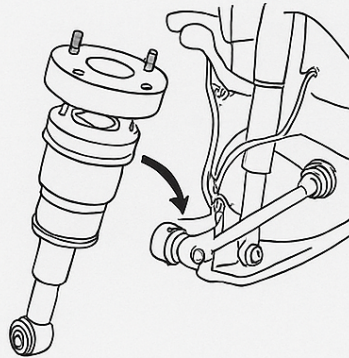

Install the 2½" Spacer

- Mount the spacer on top of the strut assembly

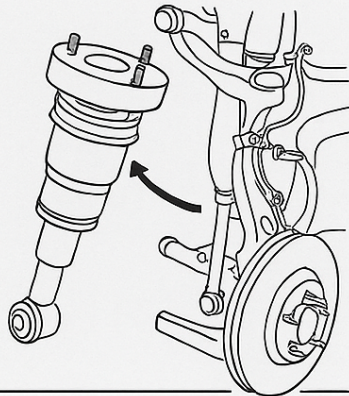

VOID Improper installation or the use of incompatible parts could void the vehicle's warranty.