



Revel Basic Lift Installation Instructions

IMPORTANT! PLEASE READ ALL INSTRUCTIONS FIRST! If in doubt, please contact our sales department before installation. If you feel you lack the necessary skills please have your links installed by a professional mechanic. Revel Performance Inc. or it's suppliers will not be held liable for any loss or injury due to improper installation.

FOR YOUR SAFETY Adjustable sensor links with front spacers are intended to improve off-road performance. Modifying your vehicle for off-road use may result in the vehicle handling differently than a factory equipped vehicle. Extreme care must be used to prevent loss of control or vehicle rollover. Failure to drive your modified vehicle safely may result in serious injury or death. Revel Performance Inc. does not recommend the combined use of suspension lifts, body lifts, or other lifting devices. You should never operate your modified vehicle under the influence of alcohol or drugs. Always drive your modified vehicle at reduced speeds to ensure your ability to control your vehicle under all driving conditions. Always wear your seat belt.

Revel Basic Lift Component List

Description	Quantity
Front Spacers	2
Spacer Hardware Kit	1
Adjustable Links (Front)	2
Adjustable Links (Rear)	2

Note the instructions provided in Appendix A cover the spacer installation. Revel Spacers can only be used on an air ride RAM when used in combination with the Revel adjustable sensor links.

- Install the spacers following the instructions in Appendix A. Refer to tips on page 2 during installation. The spacers **cannot** be installed on your truck without the Revel adjustable sensor links. Following the installation of the Spacers you need to swap the factory sensor links with our adjustable links. Picture #1 shows the proper installation of the adjustable links.
- For **4th Gen Trucks** (2013-2018) the longer links go on the front and the shorter links are for the rear.
- For **5th Gen Trucks** (2019-2024) the shorter links go on the front and the longer links are for the rear.
- If Preadjusted links were selected on checkout no adjustments to the links will be required.
- If Preadjusted links was not selected:
Front links need to be slightly shorter than the stock links
Rear links need to be slightly longer than the stock links



Picture #1

Installation Tips:

- Place truck in “Transport Mode” by selection from the EVIC
- When re-installing the sway bar end links do both left and right following installation of the spacers on both sides as a last step.
- The airline can be removed by disconnecting the hose at the black fitting or removing the brass fitting. It is normal to hear a small amount of charge escape when the hose is disconnected, approx. 1-2 seconds max. Note: The airline can be removed over 20 times before a recharge of the air ride system would be needed.
- When re-installing the upper ball joint nut use a second wrench to prevent the ball joint from turning, see picture #2.

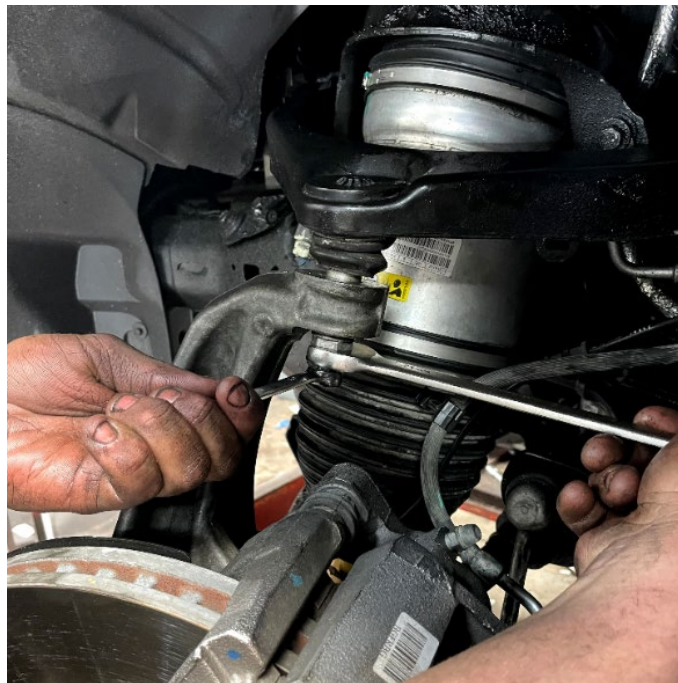

Picture #2

- The entire air strut assembly should be rotated 180 degrees to ensure proper alignment of the mounting studs.

Spacer Image



Always looking to add more pictures of vehicles to the site.
If you would like yours on there, send them to sales@revelperformance.com

Thank you for your purchase. If you have any questions please don't hesitate to ask anytime via phone or Email.

Revel Performance
407-77-REVEL
sales@revelperformance.com
www.revelperformance.com

Appendix A

Revel Spacer Installation Instructions

Installation Instructions

For Adding a 2½" Spacer on Top of the Front Air Cylinder Assemblies on a Ram 1500 with Air Ride

 **WARNING:** Improper installation can result in suspension failure, poor handling, or air line damage. Professional installation by a certified technician is strongly recommended. Not responsible for altered products.

Tools & Materials Needed:

- Floor jack & jack stands (or a lift)
- Lug wrench
- Metric Sockets & wrenches
- Torque wrench
- Trim tool or pry bar
- 2½" front spacers
- Safety gear (gloves, eye protection)

Installation Instructions:

1. Preparation

- Park the Truck on level ground, engage the parking brake.
- Disable air suspension via Uconnect (Jack or Transport Mode) or pull the air suspension fuse.
- Disconnect the negative battery terminal.

2. Raise the Vehicle

- Loosen front lug nuts.
- Lift the front of the truck and secure with jack stands.
- Remove front wheels.

3. Access the Front Air Strut Assembly

- Remove the plastic inner fender liner (may or may not be needed).
- Remove sway bar bolt and move sway bar.
- Disconnect ABS lines.

4. Disconnect the Air Line

- Disconnect the air line carefully using the correct tool and cap it.
- Remove factory air suspension sensor link.

5. Remove the Strut Assembly

- Place jack under lower control arm
- Remove upper ball joint bold and remove from knuckle (Strike side of knuckle with hammer)
- Remove tie rod bolt and remove from knuckle (Strike side of knuckle with hammer)
- Remove the three top strut nuts and the lower control arm bolt.
- Lower jack enough to remove strut.

- Carefully remove the strut assembly.

6. Install the 2½" Spacer

- Install stud bolts into spacer.
- Mount the spacer to the top of the air strut using the provided hardware.
- Ensure correct orientation.

7. Reinstall the Strut Assembly

- Place the strut with spacer back into position.
- Reinstall lower strut bolt
- Raise lower control arm with jack until strut is seated in top mount. Secure with factory nuts. (Torque to 40 ft-lbs)
- Reinstall upper ball joint in knuckle. (Torque to 70 ft-lbs)
- Reattach ABS lines.
- Reconnect the airline.
- Reattach tie rod and sway bar.
- Check for proper torque on all fasteners.
- Repeat all steps on the other side of the Truck.
- Install Revel adjustable sensor links

8. Reinstall Wheels & Lower the Truck

- Reinstall wheels and torque lug nuts (130 ft-lbs).
- Lower the vehicle.

9. Reactivate Air Suspension

- Reconnect battery.
- Re-enable air suspension system.
- Start the vehicle and allow the system to re-pressurize.

10. Final Checks

- Test drive at low speed.
- Inspect for leaks or errors.
- Get a professional alignment.

✅ These spacers do not lift the vehicle by increasing spring preload, but by repositioning the strut mounting height.

⚠ VOID: Improper installation or incompatible parts could void your vehicle's warranty.

INSTALLATION INSTRUCTIONS

FOR ADDING A 2½" SPACER ON TOP OF THE FRONT AIR CYLINDER ASSEMBLIES ON A RAM 1500 WITH AIR RIDE



WARNING Improper installation can result in suspension failure, poor handling, or air line damage. Always follow the spacer kit manufacturer's specific instructions and ensure all parts are compatible with *Ram 1500^{ar}*

Raise the Vehicle

- Disable the air suspension
- Disconnect the negative battery terminal

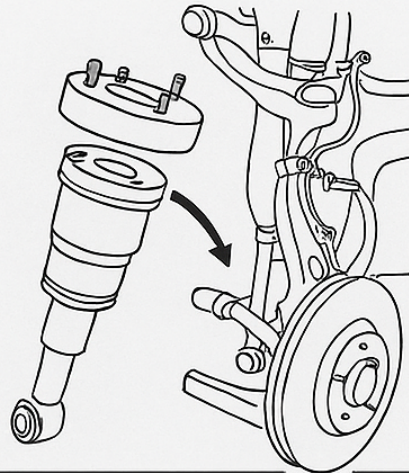
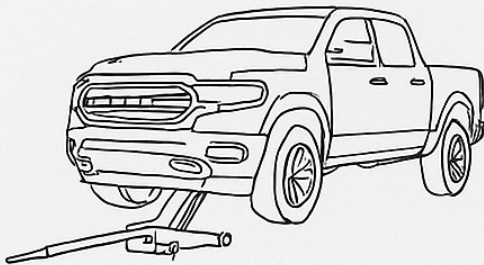

Remove the Strut Assembly

Release the air pressure and disconnect the air line

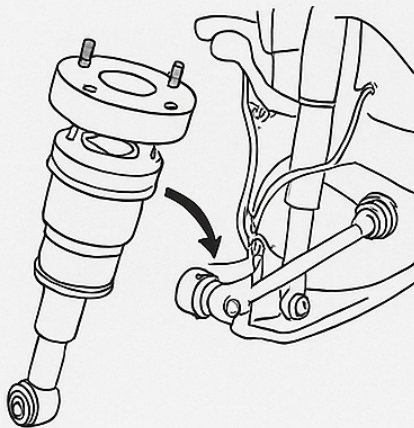

Install the 2½" Spacer

- Mount the spacer on top of the strut assembly

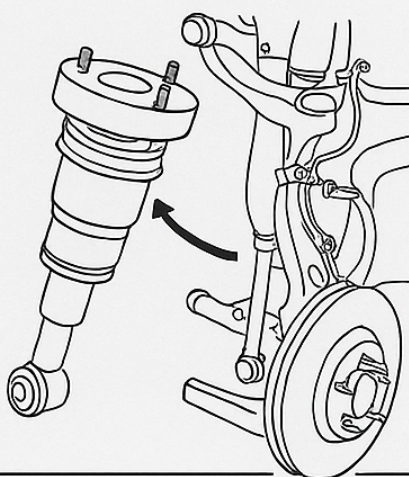

VOID Improper installation or the use of incompatible parts could void the vehicle's warranty.